



Delapre Crescent Road
Northampton,

oriordanbond
SALES & LETTINGS



GROUND FLOOR
496 sq. ft. (46.1 sq. m.) approx.



1ST FLOOR
496 sq. ft. (46.1 sq. m.) approx.

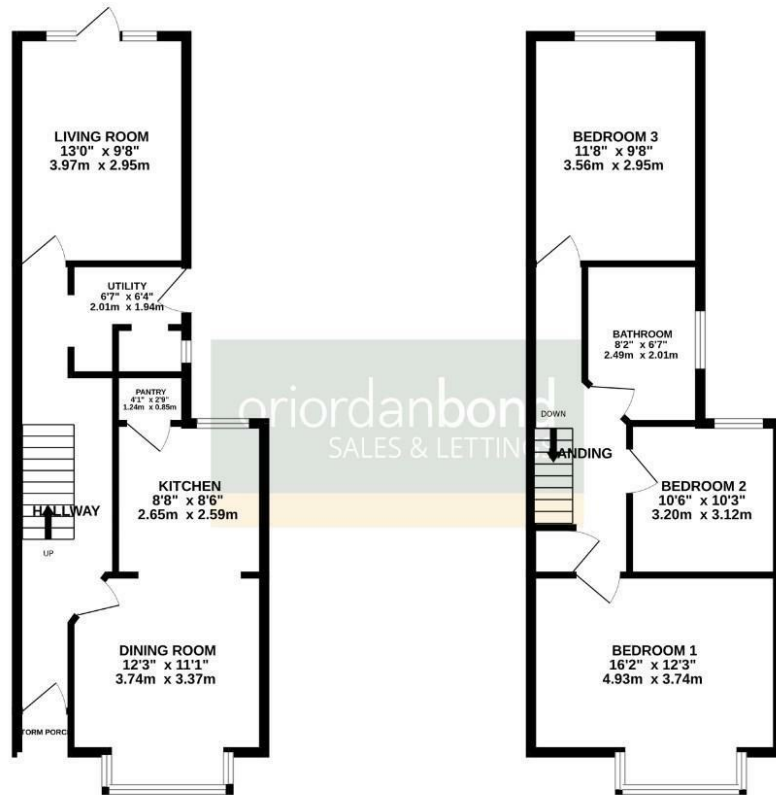

TOTAL FLOOR AREA: 992 sq. ft. (92.2 sq. m.) approx.
Whilst every attempt has been made to ensure the accuracy of the floorplan contained here, measurements of doors, windows, rooms and any other items are approximate and no responsibility is taken for any error, omission or mis-statement. This plan is for illustrative purposes only and should be used as such by any prospective purchaser. The services, systems and appliances shown have not been tested and no guarantee as to their operability or efficiency can be given.
Made with Metropix CO2DR

Delapre Crescent Road

Northampton
NN4 8NQ

PRICE £220,000

This three double bedroom double bay fronted mid terraced home is offered for sale in the very popular Far Cotton, part of NN4.

The accommodation comprises entrance hall with stairs to first floor, open fitted kitchen/dining room with box bay window to front, living room with door to rear garden and utility. The first floor has three double bedrooms and a family bathroom suite. To the front is a small courtyard enclosed by low brick wall. The rear garden has a patio area with the remainder laid to lawn, enclosed by timber fencing to all sides. Further benefits include uPVC double glazing and gas central heating. (C/992/S)

Additional information

- Council Tax Band: B
- Energy Efficiency Rating:

Viewing

Viewing strictly by appointment – details below

Disclaimer

O’Riordan Bond Estate Agents Limited has not tested apparatus, equipment, fittings or services and so cannot verify they are in working order. The buyer is advised to obtain verification from their solicitor or surveyor.

O’Riordan Bond Far Cotton Sales
01604 706007

farcotton@oriordanbond.co.uk

